

JULY 2021 HOUSE OF THE MONTH

Special Package Pricing Available through January 2022



JONESVILLE RANCH DUPLEX

Investor Series Specifications

- 1,740 sq. ft. total building
- (2) 813 sq. ft.

1BR/1Bath Apartments

(Excludes entry & storage/mechanical area)

JONESVILLE RANCH DUPLEX

Investor Series Specifications

JUNE 2021

**HOUSE
OF
THE MONTH**

DESCRIPTION



The Jonesville's single front entry door coupled with the featured saddle roof porch package make this plan's handsome exterior a welcome addition to any neighborhood. The front entry hall leads to the two private apartment entrances.

Each one bedroom/one bath apartment greets residents with a wide view of the open living, dining and kitchen area. The kitchen space includes an island/bar, efficient workspace and a pantry cabinet. The sliding patio door adds lots of natural light and leads to back yard outdoor space. The nicely sized bedroom of each apartment includes a large walk-in closet and is just steps away from additional storage space and main bath. An attractive exterior coupled with premium apartment features make the Jonesville Duplex a desirable plan for renters and a great investment value.



JONESVILLE RANCH DUPLEX

Investor Series Specifications

JUNE 2021

**HOUSE
OF
THE MONTH**

**EXTERIOR
FEATURES**



- 7/12 pitch Saddle Roof/Porch Package (std. roof this plan is 6/12--no porch)
- 3 over 1 window grids throughout
- (4) pairs louvered shutters
- (1) additional front porch light (1 light on latch side of door is std.)
- RCDT Front Door with (2) RCSJ sidelites (primed--paint optional)
- Vinyl board & batten siding for porch area



JONESVILLE RANCH DUPLEX

Investor Series Specifications

JUNE 2021

**HOUSE
OF
THE MONTH**

**INTERIOR
FLOOR PLAN**

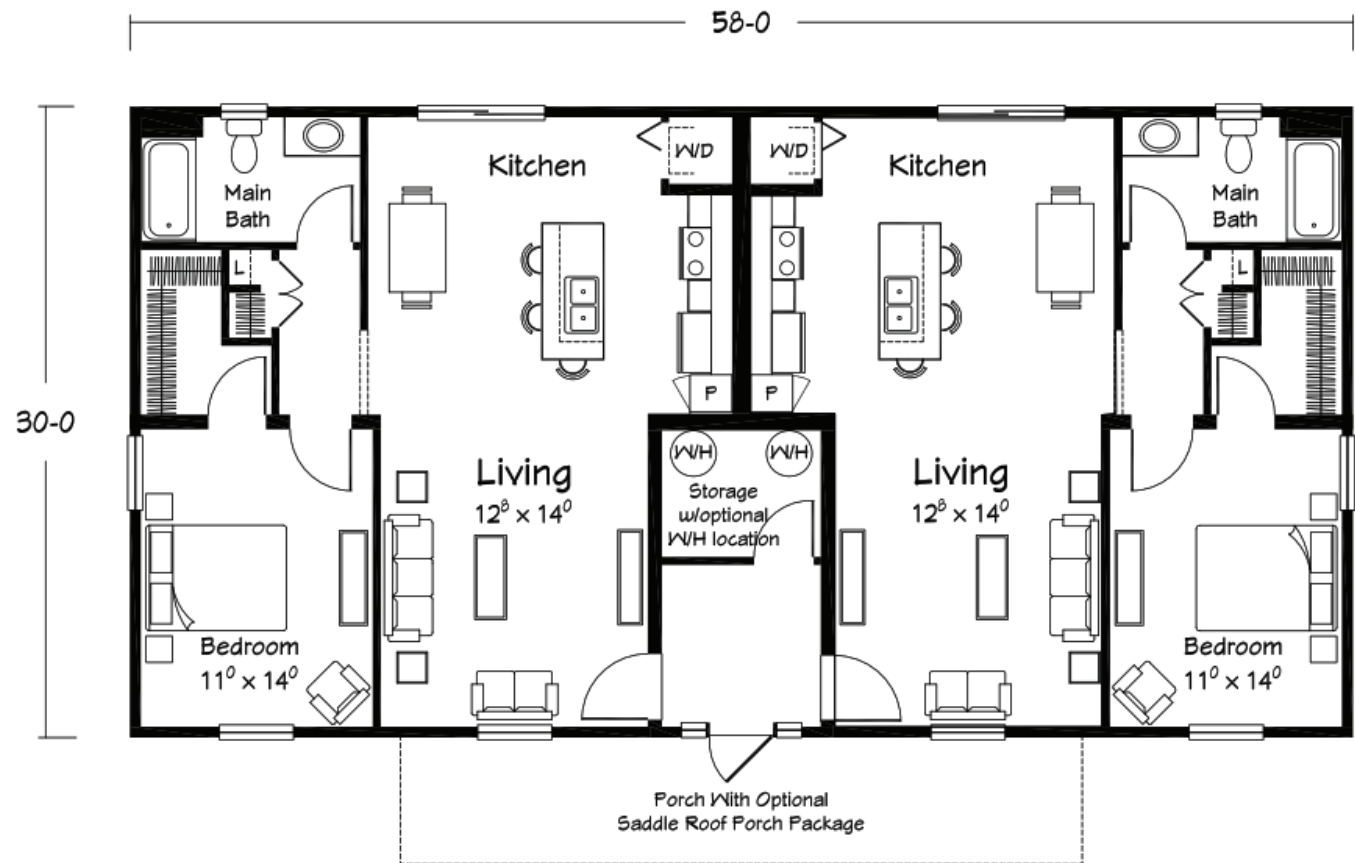
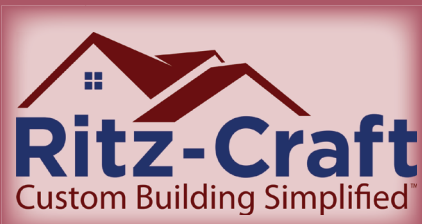

Jonesville Ranch Duplex
813 sq ft Apartments
Std. Roof Pitch 6/12 - Opt. 7/12 Pitch available
(Crawl Space std. - Basement Plan option)

JONESVILLE RANCH DUPLEX

Investor Series Specifications

JUNE 2021

**HOUSE
OF
THE MONTH**

**INTERIOR
FEATURES**



- CONGOLEUM LUX vinyl flooring in baths
- EUREKA 7 x 48" LVP flooring in Kitchen/Dining/Living Room areas
- (4) recessed ceiling lights in each kitchen