

American Dream Collection

JANUS COTTAGE

Benchmark Specifications

January 2021
HOUSE OF THE MONTH

Special Package Pricing Available
Through June 2021



• 1 BEDROOM • 1 BATH • 688 Sq. Ft.
Crawl Space Plan ONLY

American Dream Collection

JANUS COTTAGE

Benchmark Specifications

JANUARY 2021 HOUSE OF THE MONTH: DESCRIPTION

The Janus Cottage can be your perfect getaway cottage or, in some locations, may be an option for those seeking an accessory dwelling unit (ADU). The plan's compact design includes many features that make it completely comfortable for short term stays or for permanent residence. The covered entry opens to a broad view of the living/kitchen/dining areas. The kitchen, with its large prep & dining island can include full size appliances including a dishwasher. Just off the kitchen is a neatly stowed laundry area ready for a full sized, stack unit. The bedroom features nice transom windows over the bed area for plenty of light and can have private access to the bath. The Janus' sleek, modern exterior style, combined with its open and spacious feeling interior design, exhibits charming style combined with minimalist elements.

American Dream Collection

JANUS COTTAGE

Benchmark Specifications

JANUARY 2021 EXTERIOR FEATURES INCLUDED IN THE HOUSE OF THE MONTH PACKAGE

- Recessed entry includes 2x8 PT porch floor framing with 5/4 PT floor decking (decking unfinished)
- 4" porch post wrapped with AZEK (or equal) trim material (railings not included)
- RCDDR front door (primed--paint optional)
- (2) 496860ZL16 porchlights (1 front--1 at sliding door)
- 1x10 HARDI (or equal) sill trim for 4 sides of house and porch perimeter (shipped for site installation)
- 1x4 HARDI (or equal) vertical trim boards flanking doors and windows on front and sides of house
- Vinyl board and batten siding on 2 sides of front entry and above/below windows on front and sides of house
- Combination horizontal and board and batten siding as shown
- (3) 3112 fixed transom windows in Master Bedroom
- (1) 3112 fixed transom window in Master Closet
- (2) 3112 fixed transom windows in Hall
- (1) 3112 fixed transom window in Living Room
- Combination cottage style and operable transoms as shown per print
- 1x6 trim board above windows on left side elevation



NOTE: SHOWN WITH SITE ADDED DECK.

JANUS COTTAGE

Benchmark Specifications

JANUARY 2021 INTERIOR FEATURES INCLUDED IN THE HOUSE OF THE MONTH PACKAGE

- Angled ceiling throughout Living and Kitchen (8' flat ceilings balance of house)
- Stainless steel "tower" range hood
- EUREKA 7" x 8" LVP throughout (except bath)
- RevoTile 12" x 24" ceramic tile flooring in Bath
- Upgrade Formica 180 FX laminate tops in Kitchen and Bath
- Floating lav cabinet with vessel sink in Bath
- Seated shower pan with tiled walls and chrome roller-door enclosure
- (4) recessed ceiling lights in Living Room
- (4) recessed ceiling lights in Kitchen
- (2) "Modern Collection" hanging pendant lights over island/bar
- Pocket doors per plan
- Arts & Crafts interior trim package with 2-panel interior doors
- 42" wall cabinets with open face cabinets on range side of kitchen
- 24" deep built-in refrigerator cabinet

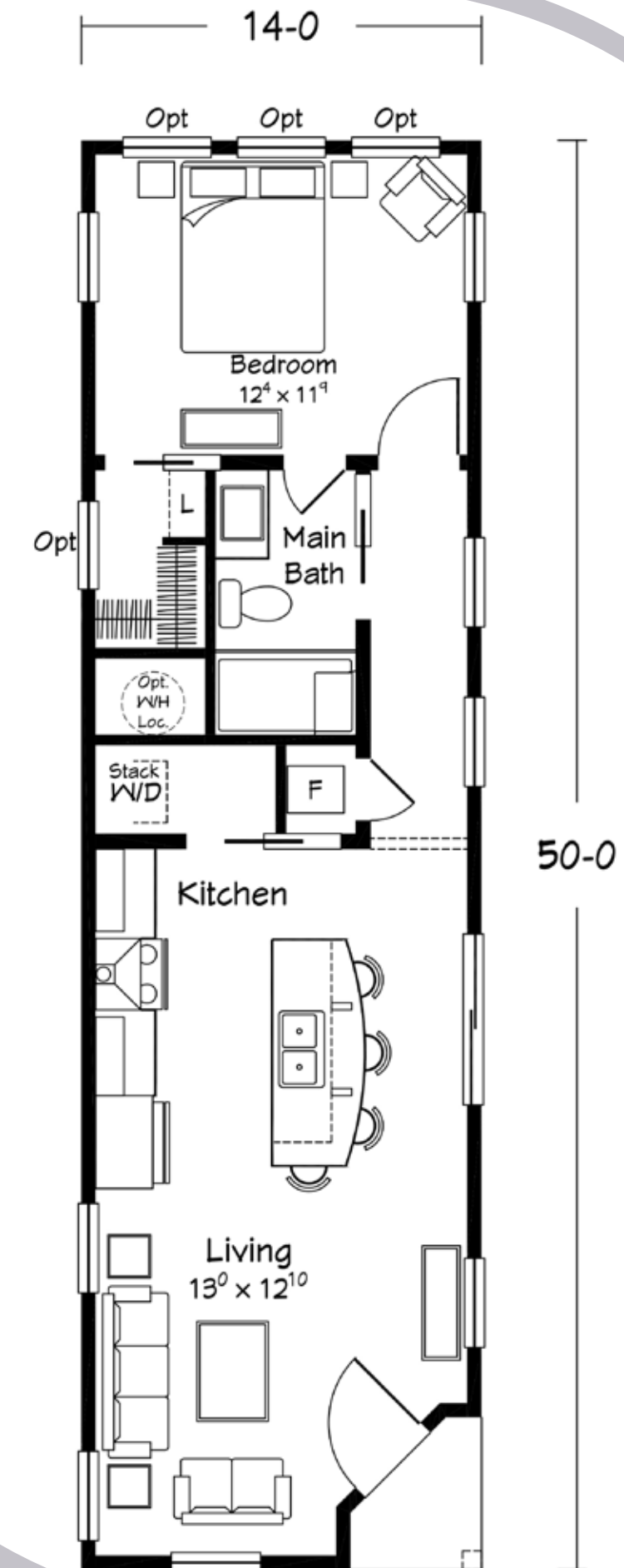

American Dream Collection

JANUS COTTAGE

Benchmark Specifications

JANUARY 2021 INTERIOR VIEWS IN THE HOUSE OF THE MONTH PACKAGE



NOTE: INTERIOR RENDERINGS SHOW OPTIONAL APPLIANCES AND FURNISHINGS WHICH ARE NOT INCLUDED.